

Overview

AT A GLANCE

- All-in-one form factor with three spindle support
- Choice of Intel Pentium® processor up to 300 MHz
- 12.1-inch CSTN/CTFT display with resolutions up to 800 x 600 or 13.3/14.1-inch CTFT display with resolutions up to 1024 x 768
- 32-MB standard SDRAM, expandable up to 160 MB
- MultiBay supports additional battery, second Hard Drive, floppy diskette drive (standard), SuperDisk LS-120.
- Up to 5-GB¹ Upgradable SMART Hard Drives
- 24X Max² CD-ROM Drive upgradable to DVD-ROM
- Integrated K56flex³ data/14.4 Kb/s fax modem (upgradable to V.90)
- Sound Blaster Pro-compatible with 16-bit stereo Compaq Premier Sound™, integrated speakers and microphone
- Intelligent Manageability for lower total cost of ownership
- Compaq Services, including a one year, Worldwide Limited Warranty⁴ with second business day⁵ expedited pick-up and repair in North America.

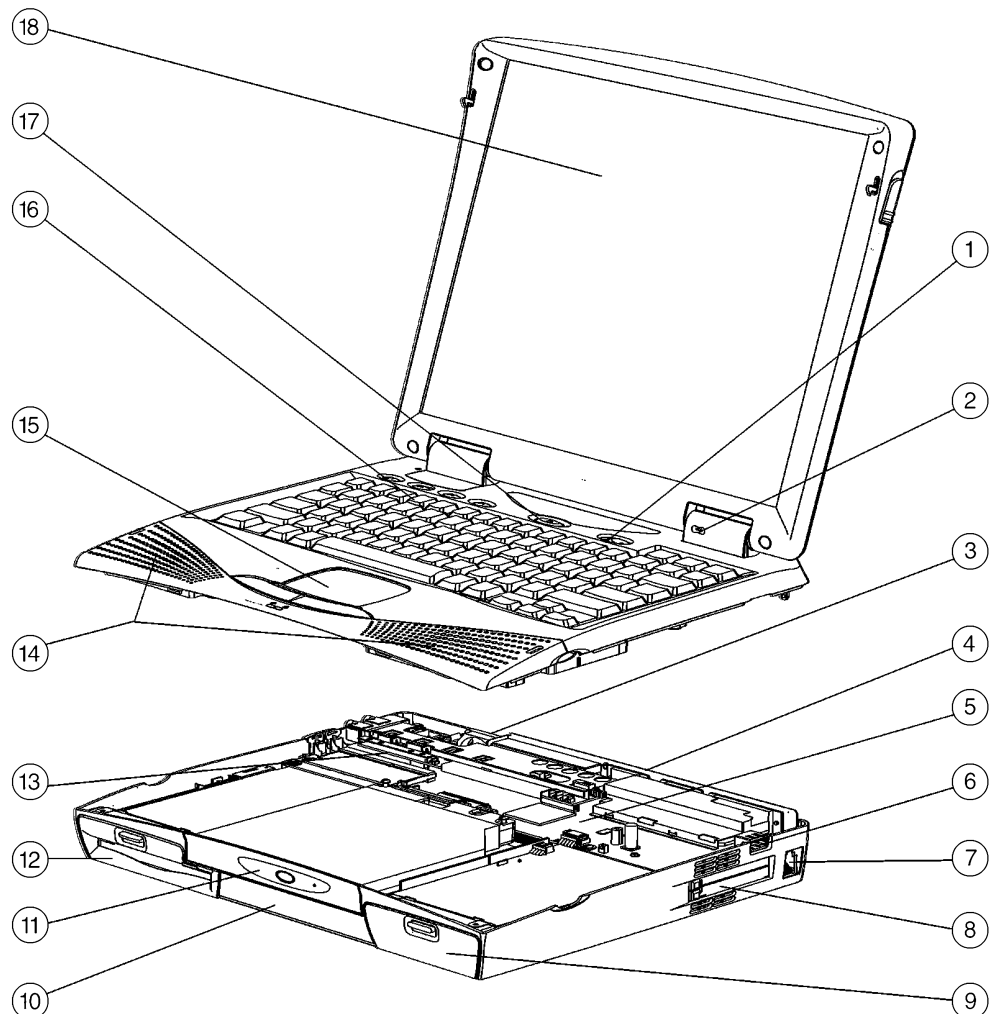

- | | |
|---|--|
| 1. Power Button | 11. 24 Max ² CD-ROM Drive upgradable to DVD-ROM Drive |
| 2. Microphone | 12. MultiBay (supports additional battery, Second Hard Drive, Zip Drive, SuperDisk LS-120 Drive) |
| 3. 4 MB/s ⁶ Infrared Communication Port | 13. Memory Slot |
| 4. Integrated AC Adapter | 14. Stereo Speakers |
| 5. Processor Board | 15. Touchpad Pointing Device |
| 6. USB Port (model dependent) | 16. Full-size Keyboard with Four User-programmable Keys |
| 7. Integrated 56Kflex ³ Data/14.4 Kb/s Fax Modem (upgradeable to V.90) | 17. Standby Button |
| 8. Two Type II/One Type III PC Card Slots; Card Bus-capable ⁷ | 18. Display |
| 9. Li-Ion Battery Pack | |
| 10. Upgradable SMART Hard Drive | |

QUICKSPECS

Compaq Armada 1700

Standard Features

MODELS

**Windows 95
(14.1 CSTN)**
6300/T/5000/D/M/1
316330-002

(13.3 CTFT)
6266/T/4000/D/M/1
316400-002

(12.1 CTFT)
6233/T/4000/D/M/1
316300-002

(12.1 CSTN)
6233/S/3200/D/M/1
316200-002

All-in-one Design

All-in-one design includes integrated Diskette Drive, Hard Drive, CD-ROM Drive, modem and AC Adapter, providing full functionality in the office or on the road. MultiBay supports diskette drive, second hard drive, second battery, SuperDisk LS-120 Drive or Zip Drive for additional flexibility.

Processor

Intel Mobile Pentium II processor 300 MHz
6300/T/5000/D/M/1

Intel Mobile Pentium II processor 266 MHz
6266/T/4000/D/M/1

Intel Mobile Pentium II processor 233 MHz
6233/T/4000/D/M/1
6233/S/3200/D/M/1

Cache Memory

Integrated 16 KB; 512-KB level 2

Memory

Standard	32 MB
Maximum	160 MB

Communications

K56flex³ data/14.4 Kb/s fax modem with full-duplex speakerphone, upgradable to V.90

Keyboard

101/102-key compatible keyboard with isolated, inverted-T cursor control keys, and right-control key, four user-programmable keys, special feature hotkeys for instant access to power conservation, QuickLock/QuickBlank, toggle between internal and external, or simultaneous displays, battery gauge, speaker volume control, brightness and contrast

Pointing Device

Touchpad pointing device for intuitive use

PC Card Slots

Two Type II/One Type III PC Card Slot(s) which support both 32-bit CardBus⁷ and 16-bit PC Cards; zoomed video support in bottom slot only

Storage

Removable Diskette Drive	1.44 MB
CD-ROM	24X Max ²
Hard Drives	Up to 10 GB ¹

Multimedia

Compaq PremierSound for enhanced stereo audio, including integrated 16-bit Sound Blaster Pro-compatible stereo audio, integrated acoustic bass reflex stereo speakers with 2 Watt/channel amplifier and 4 stage EQ, software/hardware volume control, headphone out, microphone in jacks support, software MPEG1 support; internal 24X Max² CD-ROM Drive

Standard Features

Interfaces

PC Card	Two Type II/One Type III
Enhanced Parallel	1
Serial	1
External Monitor	1
External Keyboard/ Pointing Device	1
Convenience Base	1
Headphone/Line out	1
Microphone in	1
AC Power	1
RJ-11	1
Infrared	1 (4 Mb/s ⁶ support)
USB	1

Graphics

64-bit video graphics with 2-MB EDO DRAM for increased color depth and graphics performance

Display

14.1-inch color TFT with 1024 x 768 resolution (up to 64K colors internal)
6300/T/5000/D/M/1

13.3-inch color TFT with 1024 x 768 resolution (up to 64K colors internal)
6266/T/3200/D/M/1

12.1-inch color TFT with 800 x 600 resolution (up to 16.7M colors internal)
6233/T/4000/D/M/1

12.1-inch high-contrast color, Fast Response STN with 800 x 600 resolution (up to 16.7M colors internal)
6233/S/3200/D/M/1

Software

Windows 95
Compaq Intelligent Manageability
Microsoft Internet Explorer 4.01
CompuServe and AOL
Microsoft NetMeeting
Microsoft PC Card Manager

OS Support

Windows NT Workstation 4.0
Windows 98
Windows 95

Intelligent Manageability

Lowers total cost of ownership by providing enhanced security, asset management, fault prediction with SMART drives; also provides SMART drive alert, battery fault alert, thermal alert and memory alert for investment and data protection

Standard Features

Security

Cable lock support
Power-on password
Set-up passwords
Ability to disable serial port, parallel port, diskette drive, diskette drive boot sequence
Drive Lock for advanced data protection

Power Supply

Integrated AC Adapter for less bulky transportation and 10-foot power cord

Battery

Li-Ion providing up to two-and-a-half hours of battery life⁸ supported with one battery; a second battery can be supported in the MultiBay for additional battery life

Power Conservation

Hibernation, Instant-On via Standby; pop-ups with three presets and one custom level of power conservation, ACPI hardware ready

Service and Support

Compaq Services provides a range of services for the Armada 1700, including a one-year, Limited Warranty⁴, with 7 x 24 service line at 1-800-OK-Compaq (1-800-652-6672) and a free one-year second business day⁵ pick-up and delivery service from Compaq. All shipping and handling materials are supplied by Compaq.

Options

Memory

128-MB Memory Upgrade	315177-B21
64-MB Memory Upgrade	314891-B21
32-MB Memory Upgrade	314890-B21
16-MB Memory Upgrade	314889-B21

Monitors⁹

TFT8000 Flat Panel	307906-001
TFT5000 Flat Panel	325700-001
P1100 Color ¹⁰	325606-001
P900 Color	386326-001
P700 Color	380207-001
P110 Color ¹⁰	325600-001
P75 Color	307806-001
V1000 Color	351757-001
V900 Color	303500-001
V500 Color	325900-001
S910 Color	138485-001
S900 Color	360562-001
S710 Color	152991-001
S700 Color	360512-001

Hard Drives

5-GB ¹ SMART Hard Drive	316248-B21
4-GB ¹ SMART Hard Drive	316247-B21
3.2-GB ¹ SMART Hard Drive	255240-B21

MultiBay Options

Zip Drive	316311-B21
SuperDisk LS-120 Drive	316257-B21
DVD-ROM Drive Kit	316258-B21

PC Cards/Communications

56K ³ PC Card Modem	295050-001
USB CardBus ⁷ Card	296501-B21
10/100 TX PC Card UTP Controller	335506-B21
10 T PC Card UTP Controller	292806-B21
10 2 PC Card Coax Controller	292807-B21
10/100 TX PC Card UTP Controller Upgrade	292813-B21
100BaseTX Ethernet Upgrade	225435-001
16/4 TR PC Card IBM UTP/STP Controller	301208-B21

For additional compatible PC Cards, view the Compaq PC Card Solutions List on the Compaq website at <http://www.compaq.com/support/techpubs/pcmcia/pccardlist.html>.

Convenience Bases

Armada Convenience Base II with USB (Ethernet) ¹¹	316239-001
Convenience Base II with USB (Pass-Through) ¹¹	316238-001
Monitor Stand-Conversion Kit ¹²	316246-B21

Power

Li-Ion Battery	254936-B21
External Battery Charger	254938-B21
Auto/Aircraft Adapter	296537-B21
AC Line Cord (10-ft)	217932-002

Input Devices

External Infrared Transceiver	220687-002
External Enhanced III Keyboard (Beach Gray)	110562-001
External Enhanced III Keyboard (Opal)	294343-001
Compaq Mouse (Beach Gray)	143315-001
Compaq Mouse (Opal)	143315-B21

Other

Security Lock	294316-B21
Portable Video Conferencing Kit	296954-001
Armada Headset with microphone	220460-001
Universal Monitor Stand	294315-B21

Carrying Cases

Compaq Value Case	294266-B21
Compaq Workstation Case	294267-B21
Compaq Global Case	294268-B21
Compaq Executive Case	294269-B21

For additional Compaq Brand cases, call 1-800-888-5903.

Memory

Compaq Armada 1700

STANDARD MEMORY

32 MB Standard on System Board (1 slot available)

Standard	Slot
32 MB	<div>1</div> <div>Empty</div>

STANDARD MEMORY PLUS

OPTIONAL MEMORY

Support for up to 160 MB of 60 ns SDRAM is available with the installation of optional SDRAM Memory Upgrade.

Up To	Slot
	<div>1</div>
48 MB	<div>16 MB</div>
64 MB	<div>32 MB</div>
96 MB	<div>64 MB</div>
160 MB	<div>128 MB</div>

Following are memory options available from Compaq:

- | | |
|-------------------------|------------|
| • 128-MB Memory Upgrade | 315177-B21 |
| • 64-MB Memory Upgrade | 314891-B21 |
| • 32-MB Memory Upgrade | 314890-B21 |
| • 16-MB Memory Upgrade | 314889-B21 |

Storage

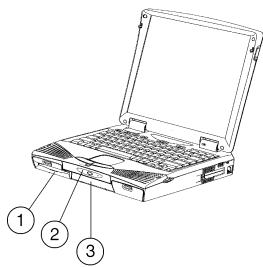

- 1 MultiBay
- 2 CD-ROM Drive Bay
- 3 Upgradable Hard Drive

DRIVE SUPPORT

	Quantity Supported	Position Supported
Removable Media		
1.44-MB Diskette Drive	Up to 1	Dual Bay
24X Max ² CD-ROM Drive (optional DVD)	Up to 1	CD-ROM Drive Bay
Hard Drives		
5-GB ¹ SMART Hard Drive	Up to 1	Upgradable Hard Drive
4-GB ¹ SMART Hard Drive	Up to 1	Upgradable Hard Drive
3.2-GB ¹ SMART Hard Drive	Up to 1	Upgradable Hard Drive

Technical Specifications

System Unit

Dimensions (HxWxD)	2.3 x 12.5 x 9.6 in/5.84 x 31.75 x 24.5 cm
Weight	
Armada 1700 6233/S/3200/D/M/1	7.96lbs/3.62 kg
Armada 1700 6233/T/4000/D/M/1	7.85 lbs/3.57 kg
Armada 1700 6266/T/4000/D/M/1	8.3 lbs/3.76 kg
Armada 1700 6300/T/5000/D/M/1	8.32 lbs/3.78 kg
Stand-Alone Power Requirements	
Nominal Operating Voltage (Li-Ion)	14.2 VDC
Maximum Operating Power	45W
Peak Operating Power	50W
Temperature	
Operating	50° to 95°F/10° to 35°C
Non-operating	-4° to 140°F/-20° to 60°C
Relative Humidity (non-condensing)	
Operating	10% to 90%
Non-operating	5% to 95%
Shock	
Operating	10 G, 11 ms, half-sine
Non-operating	60 G, 11 ms, half-sine
Vibration	
Operating	0.25 G, 1 Oct/Min sweep rate
Non-operating	1 G, 1 Oct/Min sweep rate
Maximum Altitude (unpressurized)	
Operating	10,000 ft/3,048 m
Non-operating	30,000 ft/9,144 m

14.1-Inch Color TFT
1024 x 768 Display

Dimensions (HxW)	8.92 x 11.75 in/22.66 x 29.84 cm
Diagonal Size	14.1 in/35.8 cm
Mounting	Internal
Number of Colors	64K
Contrast Ratio	Minimum 100:1
Brightness	Over 120 cd/m ²
Pixel Resolution	
Pitch	0.279 x 0.279 mm
Format	1024 x 768
Configuration	RGB Stripe
Backlight	Edge Lit
Character Display	80 x 25
Total Power Consumption (maximum)	7W

Technical Specifications

13.3-Inch Color TFT 1024 x 768 Display

Dimensions (HxW)	7.9 x 10.6 in/20.1 x 26.9 cm
Diagonal Size	13.3 in/33.8 cm
Mounting	Internal
Number of Colors	64K
Contrast Ratio	Minimum 100:1
Brightness	Over 120 cd/m ²
Pixel Resolution	
Pitch	0.264 x 0.264 mm
Format	1024 x 768
Configuration	RGB Stripe
Backlight	Edge Lit
Character Display	80 x 25
Total Power Consumption (maximum)	4W

12.1-Inch Fast Response Color STN SVGA Display

Dimensions (HxW)	7.24 x 9.7 in/18.4 x 24.6 cm
Diagonal Size	12.1 in/30.7 cm
Mounting	Internal
Number of Colors	16M
Contrast Ratio	35:1 (typical)
Brightness	Over 90 cd/m ²
Response Time	150 ms
Pixel Resolution	
Pitch	0.3 x 0.3 mm
Format	800 x 600
Configuration	RGB Stripe
Backlight	Edge Lit
Character Display	80 x 25, 80 x 50
Total Power Consumption (with backlight)	6W (maximum)

12.1-Inch Color TFT SVGA Display

Dimensions (HxW)	7.24 x 9.7 in/18.4 x 24.6 cm
Diagonal Size	12.1 in/30.7 cm
Mounting	Internal
Number of Colors	16M
Contrast Ratio	Minimum 100:1
Brightness	Over 140 cd/m ² (typical)
Pixel Resolution	
Pitch	0.3 x 0.3 mm
Format	800 x 600
Configuration	RGB Stripe
Backlight	Edge Lit
Character Display	80 x 25, 80 x 50
Total Power Consumption (with backlight)	6W (maximum)

Technical Specifications

Hard Drives

5 GB¹	Capacity	5 GB ¹	Seek Time (typical reads, including settling)	
	Height	1 in/25.4 mm	Single Track	4 ms
	Size	2.5 in/63.5 mm	Average	12 ms (read)
	Interface	ATA	Full-Stroke	23 ms
	Transfer Rate		Rotational Speed	4,902 rpm
	Synchronous (Maximum)	33.3 MB	Physical Configuration	
			Bytes/sector	512
			Operating Temperature	41° to 131°F/5° to 55°C
4 GB¹	Capacity	4 GB ¹	Seek Time (typical reads, including settling)	
	Height	1 in/25.4 mm	Single Track	4 ms
	Size	2.5 in/63.5 mm	Average	12 ms (read)
	Interface	ATA	Full-Stroke	23 ms
	Transfer Rate		Rotational Speed	4,009 rpm
	Synchronous (Maximum)	33.3 MB	Physical Configuration	
			Bytes/sector	512
			Operating Temperature	41° to 131°F/5° to 55°C
3.2 GB¹	Capacity	3.2 GB ¹	Seek Time (typical reads, including settling)	
	Height	1 in/25.4 mm	Single Track	4 ms
	Size	2.5 in/63.5 mm	Average	12 ms (read)
	Interface	ATA	Full-Stroke	23 ms
	Transfer Rate		Rotational Speed	4,009 rpm
	Synchronous (Maximum)	33.3 MB	Physical Configuration	
			Bytes/sector	512
			Operating Temperature	41° to 131°F/5° to 55°C

Diskette Drive

Diskette Size	3.5 in
Light	None
Height	0.82 in/2.08 cm
Bytes per Sector	512
Sectors per track	
High density	18 (1.44 MB)/15 (1.2 MB)
Low density	9
Tracks per side	
High density	80 (1.44 MB)/80 (1.2 MB)
Low density	80
Read/Write heads	2
Access Times	
Track-to track (high/low)	3 ms/6 ms
Average (high/low)	94 ms/174 ms
Settling time	15 ms
Latency average	100 ms

Technical Specifications

Integrated AC Adapter

Weight	0.66 lb/0.3 kg
Power Supply (input)	
Operating Voltage	90 to 260 VAC RMS
Operating Current	1.1 A RMS
Operating Frequency Range	47 to 63 Hz AC
Maximum Transient	4/50 kV

Li-Ion Battery Pack

Dimensions (HxWxD)	0.82 x 3.2 x 5.8 in/2.08 x 8.13 x 14.73 cm
Weight	0.85 lb/0.39 kg
Energy	
Voltage	14.4 V
Amp-hour capacity	3.1 Ah
Watt-hour capacity	43Wh
Temperature	
Operating	50° to 104° F/10° to 40° C
Non-operating	-12° to 140°F/-25° to 60°C

Convenience Base

Dimensions (HxWxD)	4.9 x 14.2 x 14.7 in/12.46 x 36.07 x 37.34 cm
Weight	4.25 lbs/1.93 kg
Power Supply (input)	
Operating Voltage	100 to 240 VAC
Operating Current	1.1 Amp Maximum
Rated Voltage	100 to 240 VAC
Rated Current	1 Amp Maximum
Line Frequency	47 to 63 Hz
Temperature	
Operating	50° to 95°F/10° to 35°C
Non-operating	-4° to 140°F/-20° to 60°C
Relative Humidity	
Operating	10% to 90%
Non-operating	5% to 95%
Altitude	
Operating	10,000 ft/3,048 m
Non-operating	30,000 ft/9,144 m
Shock	
Operating	10 G, 11 ms, half-sine
Non-operating	140 G, 2 ms, half-sine
Vibration	
Operating	0.25 G, 5 to 500 Hz, 0.5 octave/min sweep rate
Non-operating	1 G, 5 to 500 Hz, 0.5 octave/min sweep rate
Monitor Support	Up to 85 lbs/38.56 kg
10Base-T	Categories 3, 4 or 5 UTP (2 or 4 pair); up to 328 ft (100 meters)
100Base-TX	Category 5 UTP (2 pair); up to 328 feet (100 meters)

Technical Specifications

24X Max² CD-ROM Drive

Applicable Disc	CD-DA, CD-ROM, CD-R, CD-ROM XA (except ADPCM) CD-1, Photo CD (Multi-session), Video CD, CD-Extra (CD+) CD-G, CD-RW
Center Hole Diameter	15 mm
Disc Diameter	12 cm, 8 cm
Disc Thickness	1.2 mm
Track Pitch	1.6 μ m
Laser	
Output power	0.24 \pm 0.1 mW
Type	GaAlAs double hetero laser diode
Wave length	780 nm at Ph-2.7 mW
Access Times (typical reads, including settling)	150 ms
Audio Output Level	
Line-out	\pm 0.27 Vrms
Headphone	None
Cache Buffer	128 KB
Data Transfer Rate (typical, including settling)	
Sustained (16X)	3600 KB/s 150 KB/s
Normal PIO Mode 4 (single burst)	16.66 MB/s
Start-up Time	< 8 sec
Stop Time	< 4 sec

¹ For Hard Drives, GB = Billion Bytes.

² Data transfer rates will vary from 150 KB/s to 3600 KB/s.

³ Designed only to allow faster downloads from K56flex compliant sources. Maximum achievable download transmission rates currently do not reach 56 KB/s, and will vary with line conditions. Modem only supports Windows 9.x and Windows NT 4.0.

⁴ Certain restrictions and exclusions apply. Consult the Compaq Customer Support Center for details.

⁵ Pick-up and delivery service is available in 48 contiguous US states and Canada. Eligibility for priority pick-up (2nd business day return) is limited to certain geographic locations carry-in service available outside the US and Canada.

⁶ IrDA 4 MB compliant. IR performance will vary depending on performance of IR peripherals and applications used.

⁷ Full support in Windows 9.x.

⁸ When tested in the standard configuration using the Ziff-Davis BatteryMark test version 1.0, the battery life of the Armada 1500 family will range from 2 hours and 0 minutes to 3 hours and 0 minutes depending on individual usage AssetControl monitor.

⁹ AssetControl features are accessible with Compaq desktops featuring Intelligent Manageability.

¹⁰ May not be compatible with the ArmadaStation Monitor Support Stand, the Convenience Base I or the Convenience Base II due to weight limitations.

¹¹ Armada 1500 compatible.

¹² Allows the Armada 1500 Convenience Base to support the Armada 1700.